

Product guide



HP ENVY 5530 e-All-in-One

Your convenient creation station





Compact, stylish, wireless e-All-in-One

The HP ENVY 5530 e-All-in-One offers some unique features that help it stand apart from the crowd:

- Borderless printing for lab-quality photos, flyers, laser-sharp documents, and more
- Easy, direct printing from the intuitive colour touchscreen and built-in card slot
- Convenient wireless printing from your smartphone, tablet, and notebooks¹
- Automatic two-sided printing saves paper
- HP Printables deliver news, fun, and savings directly to your e-All-in-One²
- Direct scanning to your mobile device with the HP Printer Control app³
- Fast print speeds let you knock out creative photo projects in a snap
- Easy, wireless printing right out of the box with painless setup⁴
- Optional high-capacity cartridges allow you to print more for less⁵
- ENERGY STAR® qualified to conserve resources without sacrificing performance
- Easy, free cartridge recycling through HP Planet Partners⁶

HP Printer Control app

Enjoy convenient remote access to your e-All-in-One with this free, mobile app.³ Preview, crop, and scan images and documents wirelessly from your e-All-in-One to your mobile device. Scan to email using any installed email application. Use your mobile device as a scanner to capture important information, automatically enhance, and store it as an image or document. Scan to social sharing sites, such as Facebook and Google Docs. Use your Apple® iPhone® or iPad® to control print, scan, and copy features.³ For more details, visit hp.com/go/mobileapps.

Let your imagination roam and express yourself for less with the HP ENVY 5530 e-All-in-One. Produce borderless, lab-quality photos that dazzle and laser-like documents that always look sharp. Print wirelessly—and control this e-All-in-One—from your smartphone, tablet, and Internet-connected PC.^{1,3} Make the most of your creative time. Walk up, edit, and print photo projects using the colour touchscreen and easy-access memory card slot.

Who can benefit?

This e-All-in-One is perfect for those who want the freedom to print photos, creative projects, and documents—at home or on the go, and need:

- High-quality printing from all their computing devices—smartphones, tablets, and Internet-connected PCs¹
- Versatile scanning and copying
- Easy wireless networking
- Low operating costs
- Stylish, space-saving design and eco-conscious features

Inspiration, meet affordability

Unleash your imagination and add a creative touch to all your tasks—on your budget.

- Look sharp no matter what you print. Borderless, lab-quality photos and crisp, laser-quality documents make quite the pair.
- Step up to a better value for frequent printing. Print more for less, using optional high-capacity cartridges.⁵
- Cut your paper use by up to half, and save money by getting it all on one page with automatic two-sided printing.

Print wherever creativity strikes—no wires attached¹

Now it's easy to print from your smartphone, tablet, and Internet-connected PC.¹

- Use Apple® AirPrint™ to print wirelessly from your iPad®, iPhone®, or iPod touch®.⁷
- HP's new Slate 7 tablet and Samsung's Galaxy S® 4 smartphone feature built-in print functionality for seamless mobile printing.⁸
- Print wirelessly from virtually anywhere with HP ePrint.¹ HP offers mobile printing solutions for a broad range of devices and operating systems. To learn which mobile solution is right for you, visit hp.com/go/mobileapps.
- This e-All-in-One is also Google™ Cloud Print ready, with no need for print drivers or additional software; visit google.com/cloudprint/learn/setup-hp.html for details.⁹
- HP wireless direct printing lets you print from your smartphone, tablet, or Internet-connected computer directly to your e-All-in-One—without a network or router.¹⁰

- Built-in Wi-Fi lets you print from virtually anywhere in your home, and share this e-All-in-One with wireless-enabled PCs and notebooks on your local wireless network.¹¹
- Get right to printing. Set up quickly out of the box and connect to your wireless network automatically with HP Auto Wireless Connect.⁴ Start even faster on HP PCs running Windows® 8.

Step up and create

Create and share for less

Enjoy easy, affordable printing for photos and projects. Print 50 glossy, 10 x 15 cm photos from home, using a low-cost photo value pack.¹² HP Photo Value Packs match the right ink with the right paper for brilliant, durable photos you'll be proud of. Skip the trip to the store—save time and money when you print what you want when you want.

- Create in fewer steps. Use the 6.74 cm colour touchscreen and easy-access memory card slot to view, edit, and print photos directly from your e-All-in-one.
- See it sooner. Go from idea to reality without the wait, with fast print speeds.
- Make your e-All-in-One a daily stop for fun activities, news, savings, and more. With HP Printables, get free, premium information and activities from popular brands delivered right to your device.²



There's an HP Printable for everyone

Whether you're looking for entertainment, family activities, news, business trends, or travel tips, HP Printables are ready when you are. Find yours today by selecting "Printables" on the e-All-in-One's graphic display.

Product walk around

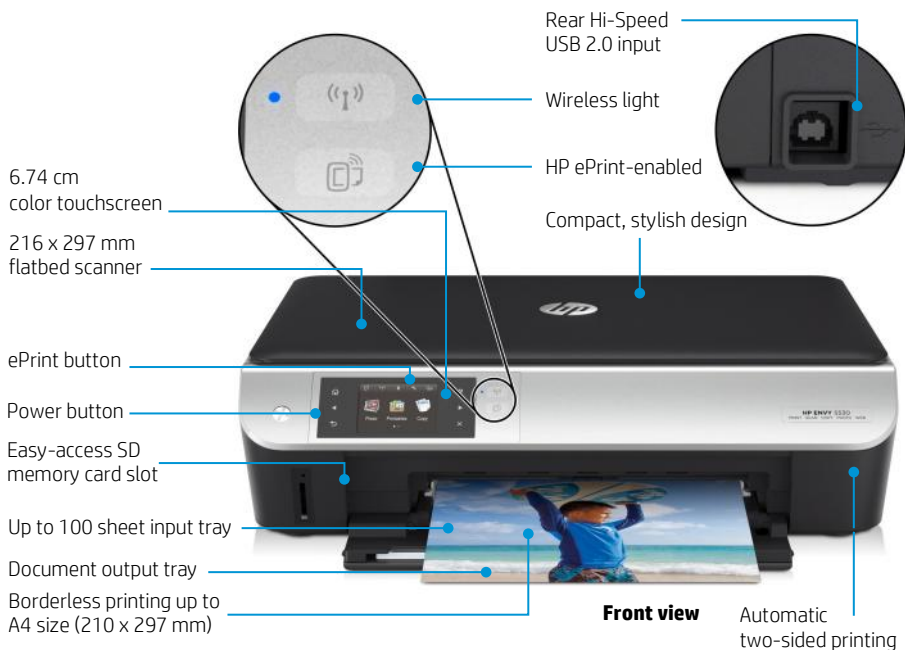

Product specifications

Product number	A9J40A
Print speed¹³	ISO: Up to 8.8 ppm black, up to 5.2 ppm colour Draft: Up to 21 ppm black, up to 17 ppm colour
Print resolution	Black (best): Up to 1200 x 600 rendered dpi (when printing from a computer) Colour (best): Up to 4800 x 1200 optimized dpi colour (when printing from a computer on selected HP photo papers and 1200 input dpi)
No. of print cartridges	1 black, 1 tri-colour (cyan, magenta, yellow)
Scan resolution	Optical: Up to 1200 dpi; Hardware: Up to 1200 x 2400 dpi; Enhanced: Up to 2400 dpi
Scan destinations	Scan to computer, scan to memory card, scan to email
Copy resolution	Black text and graphics: Up to 600 dpi; Colour text and graphics: Up to 600 x 1200 dpi
Copy reduce/enlarge	25 to 400%
Copy settings	Start Black Copy, Start Colour Copy, Number of copies, 2-sided, Draft, Quality, Resize, Lighter/darker, Paper Size, Paper Type, Margin Shift, Enhancements, Set as New Defaults
Media sizes	76 x 127 to 216 x 356 mm
Paper handling	Maximum number of paper trays: 1 Input capacities: Up to 100 sheets A4/legal; up to 30 sheets 10 x 15 cm photo paper; up to 10 envelopes Output capacities: Up to 30 sheets A4/legal; up to 10 sheets 10 x 15 cm photo paper; up to 5 envelopes
Minimum system requirements	PC: Microsoft® Windows® 8, 7: 1 GHz 32-bit (x86) or 64-bit (x64) processor, 2 GB available hard disk space, CD-ROM/DVD drive or Internet connection, USB port, Microsoft Internet Explorer. Windows Vista®: 800 MHz 32-bit (x86) or 64-bit (x64) processor, 2 GB available hard disk space, CD-ROM/DVD drive or Internet connection, USB port, Microsoft Internet Explorer. Windows XP SP3 or higher (32-bit only): any Intel® Pentium® II, Celeron® or 233 MHz compatible processor, 750 MB available hard disk space, CD-ROM/DVD drive or Internet connection, USB port, Internet Explorer Mac: Mac OS X v10.6, OS X Lion, OS X Mountain Lion; Intel Core™ Processor; 1 GB HD; CD-ROM/DVD or Internet; USB port
Compatible operating systems	PC: Windows 8, Windows 7, Windows Vista, Windows XP SP3 or higher (32-bit only); Mac: OS X v10.6, Lion, Mountain Lion
Product dimensions (width x depth x height)	445 x 608 x 390 mm with tray extended
Product weight	5.56 kg
Power¹⁴	Input power: 100-240 V (+/-10%), 50/60 Hz (+/- 3 Hz) Power usage: ENERGY STAR qualified; 13.95 watts (printing), 3.60 watts (ready), 0.93 watts (sleep), 0.20 watts (off)
Software included	HP Printer Software, HP Update, Shop for Supplies Online, HP Photo Creations
What's in the box	HP ENVY 5530 e-All-in-One, HP 301 Black Ink Cartridge, HP 301 Tri-colour Ink Cartridge, Software CD, Setup Poster, power cord. For ink volume and page yield information, visit hp.com/go/learnaboutsupplies .
Replacement cartridges	HP 301 Black Ink Cartridge, HP 301 Tri-colour Ink Cartridge, HP 301XL Black Ink Cartridge, HP 301XL Tri-colour Ink Cartridge
Warranty	One-year limited hardware warranty; 24-hour, 7 days a week phone support
HP Services and support options	HP Total Care offers a variety of extended warranties and services; go to hp.com/support .



Line of the Year

The HP ENVY 5530 e-All-in-One joins the award winning 2013 Colour Printer/MFP Line of the Year.

Notes

¹ Requires an Internet connection to an HP web-enabled printer and HP ePrint account registration. For a list of eligible printers, supported documents and image types, and other HP ePrint details, see hpconnected.com. Mobile devices and PCs require Internet connection and email capability. May require wireless access point. Separately purchased data plans or usage fees may apply. Print times and connection speeds may vary.

² Requires a wireless access point and an Internet connection to the printer. Services require registration. Availability varies by country, language, and agreements, and may require a firmware upgrade. HP Printables may not be available on all printer models, and not all apps can be set up for automatic delivery. For details, see hpconnected.com.

³ Mobile device requires wireless access point and Internet connection. Features controlled may vary by mobile device operating system. Scan/copy control requires mobile device and printer be on the same wireless network or through wireless direct connection to printer. For more details, see hp.com/go/mobileapps.

⁴ HP Auto Wireless Connect may not be available for all system configurations. Wireless performance is dependent on physical environment and distance from access point. Wireless operations are compatible with 2.4 GHz routers only. For information on compatibility, visit hp.com/go/wirelessprinting.

⁵ High-capacity Original HP 301XL Ink Cartridge not included; please purchase separately. Less cost per page compared with standard capacity Original HP 301 Ink Cartridge.

⁶ Program availability varies. Original HP cartridge return and recycling is currently available in more than 48 countries, territories, and regions in Asia, Europe, and North and South America through the HP Planet Partners program. For more information, visit hp.com/recycle.

⁷ Supports OS X[®] Lion, OS X[®] Mountain Lion, and the following devices running iOS 4.2 or later: iPad[®] (all models), iPhone[®] (3GS or later) and iPod touch[®] (3rd generation or later). Works with HP's AirPrint-enabled printers and requires the printer be connected to the same network as your OS X or iOS device. Wireless performance is dependent upon physical environment and distance from the access point. OS X, iPad, iPhone, and iPod touch are trademarks of Apple[®] Inc., registered in the U.S. and other countries. AirPrint and the AirPrint logo are trademarks of Apple[®] Inc.

⁸ Wireless access point or Internet may be required, not included. Local printing requires mobile device and printer to be on the same network. Remote printing requires an Internet connection to HP web-enabled printer and HP ePrint account registration. Wireless performance is dependent upon physical environment and distance from access point. Wireless operations are compatible with 2.4 GHz routers only. See hp.com/go/mobileprinting for more details.

⁹ Google[™] and Gmail are trademarks of Google Inc.; feature requires Google Cloud Print Ready printer or existing printer connected to a PC with Internet access. Print times may vary. Currently only Google apps are supported.

¹⁰ Mobile device must be wireless-enabled. Wireless performance is dependent on physical environment and distance from access point. Feature may require driver or apps. For more details, see hp.com/go/wirelessprinting.

¹¹ Wireless performance is dependent on physical environment and distance from access point. Wireless operations are compatible with 2.4 GHz routers only.

¹² Average based on HP testing methodology and continuous printing. Actual yield varies considerably based on content of printed pages and other factors. For details see hp.com/go/learnaboutsupplies.

¹³ Either after first page or after first set of ISO test pages. For details see hp.com/go/printerclaims.

¹⁴ Power requirements are based on the country/region where the printer is sold. Do not convert operating voltages. This will damage the printer and void the product warranty.

Sign up for updates

hp.com/go/getupdated



Share with colleagues



Rate this document

© Copyright 2013 Hewlett-Packard Development Company, L.P. The information contained herein is subject to change without notice. The only warranties for HP products and services are set forth in the express warranty statements accompanying such products and services. Nothing herein should be construed as constituting an additional warranty. HP shall not be liable for technical or editorial errors or omissions contained herein.

AirPrint and the AirPrint Logo are trademarks of Apple[®] Inc. iPad, iPhone, and iPod touch are trademarks of Apple Inc., registered in the U.S. and other countries. ENERGY STAR is a registered mark owned by the U.S. government. Galaxy S 4 is a registered trademark of Samsung Electronics Co., Ltd. Google is a trademark of Google, Inc. Intel, Celeron, Pentium, and Intel Core are trademarks of Intel Corporation in the U.S. and/or other countries. Microsoft, Windows, Windows XP, and Windows Vista are U.S. registered trademarks of Microsoft Corporation.

